

Eliche Immerse (Submerged Propellers)

Modello (Type)
HB

NIBRAL

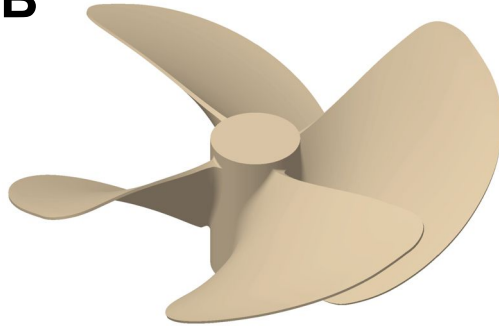

Modello (Type)
HK

NIBRAL OTMAN

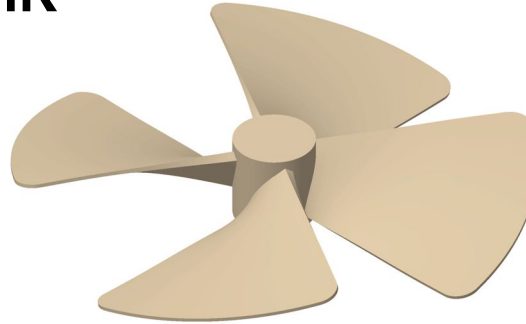

Modello (Type)
HL

NIBRAL OTMAN

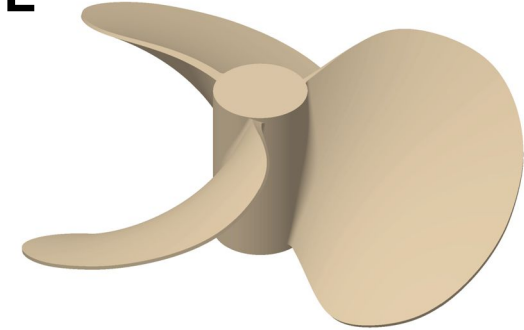

Elica immersa per scafi plananti
(submerged propeller for planing vessels)

Elica immersa di manovra e per scafi da lavoro
(submerged propeller for thruster and work boat)

Elica immersa per scafi plananti
(submerged propeller for planing vessels)

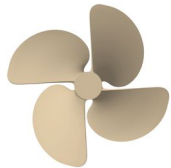

HB4 4 pale (blades)
EAR = **0,85 ÷ 0,90**
P/D max = 1,80

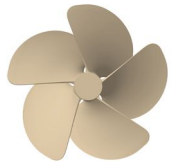

HB5 5 pale (blades)
EAR = **1,05 ÷ 1,10**
P/D max = 1,80



HK3 3 pale (blades)
EAR = **0,45 ÷ 0,65**



HK4 4 pale (blades)
EAR = **0,55 ÷ 0,70**

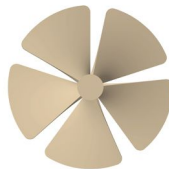

HK5 4 pale (blades)
EAR = **0,75 ÷ 0,90**

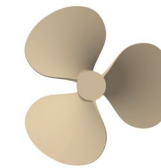

HL3 3 pale (blades)
EAR = **0,65 ÷ 0,75**
P/D max = 1,60

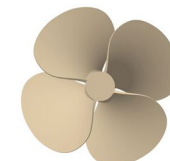

HL4 4 pale (blades)
EAR = **0,85 ÷ 1,00**
P/D max = 1,60

Eliche Immerse (Submerged Propellers)

Modello (Type) HM

NIBRAL OTMAN

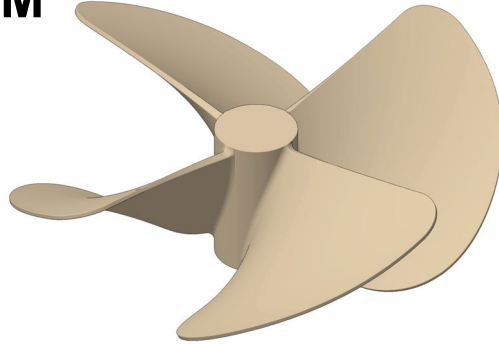

Modello (Type) HR

NIBRAL OTMAN

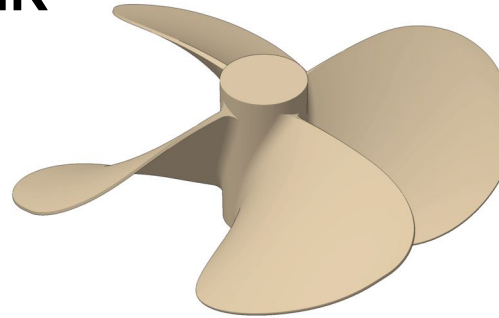

Modello (Type) HS

NIBRAL OTMAN

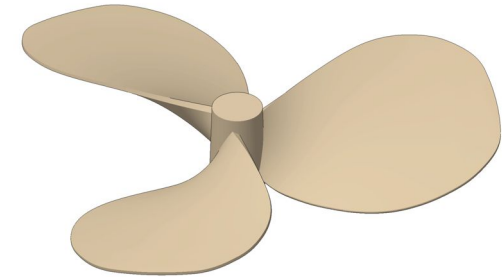

Elica immersa per scafi plananti e semiplananti
(submerged propeller for planing and semiplaning vessels)

Elica immersa per scafi plananti e semiplananti
(submerged propeller for planing and semiplaning vessels)

Elica immersa per scafi dislocanti e semiplananti
(submerged propeller for displacing and semiplaning vessels)



HM3 3 pale (blades)
EAR max = **0,65**
P/D max = 1,80

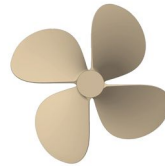

HR4 4 pale (blades)
EAR = **0,75 ÷ 0,90**
P/D max = 1,20

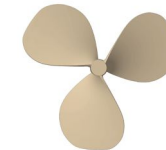

HS3 3 pale (blades)
EAR max = **0,65**
P/D max = 1,20

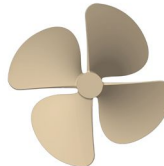

HM4 4 pale (blades)
EAR max = **0,95**
P/D max = 1,80

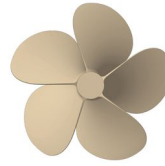

HR5 5 pale (blades)
EAR = **0,95 ÷ 1,15**
P/D max = 1,20

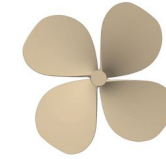

HS4 4 pale (blades)
EAR max = **0,80**
P/D max = 1,20

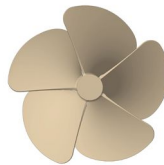

HM5 5 pale (blades)
EAR = **0,95 ÷ 1,10**
P/D max = 1,80

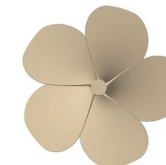

HS5 5 pale (blades)
EAR max = **0,90**
P/D max = 1,20